

# Land Rover 4x4 Equipment

## STARTER KIT & TRACK ELEMENTS

### Land Rover 4x4 in Schools Starter Packs

#### Land Rover 4x4 In Schools 'Rock Crawler' Pack

Product Code: 4x40001 (Available in UK market only)

Comprising: 1/18 Scale 4WD Rock Crawler, 2.4Ghz Transmitter with Batteries, 1 x Ni-MH Battery Pack, Battery Charger

#### Land Rover 4x4 in Schools Starter Kit

Product Code: 4x40017

The Starter Kit consists of all the essential components needed to get you started in the Challenge, ready for vehicle scrutineering and includes the following key items:-

- 1/18 Scale 4WD Rock Crawler [4X4001] – see above
- 1 x Arduino Starter Pack Comprising: 1 x Battery Clip, 1 x Transistor, 1 x Resistor of 1 KOhm, 1 x Resistor of 680KOhm, 1 x Variable Resistor, 1 x LED, 1 x LDR, Wire, 1 x Piezo buzzer
- 2 x Tilt Sensor, 1 x Lead Free Solder – 250g reel, 1 x Single-Sided Stripboard, 1 x Stripboard Cutter, 1 x Pack of 10 Straight PCB Header – 36 way



Note: Rock Crawler models may vary

### Land Rover 4x4 in Schools Track

#### Land Rover 4x4 in Schools Track

Product Code: 4x40200

Official Land Rover 4x4 in Schools Track comprising full Staging and 14 Track Elements (including 64 entry and exit cones)

#### Land Rover 4x4 in Schools Half Track: 6 Elements Only

Product Code: 4x40250

Includes: Articulation, V-Gully Traverse, Pipe Bridge, See Saw, Hill Climb, Side Slope

#### Land Rover 4x4 in Schools Flight Case for Track Elements

Product Code: 4x40191

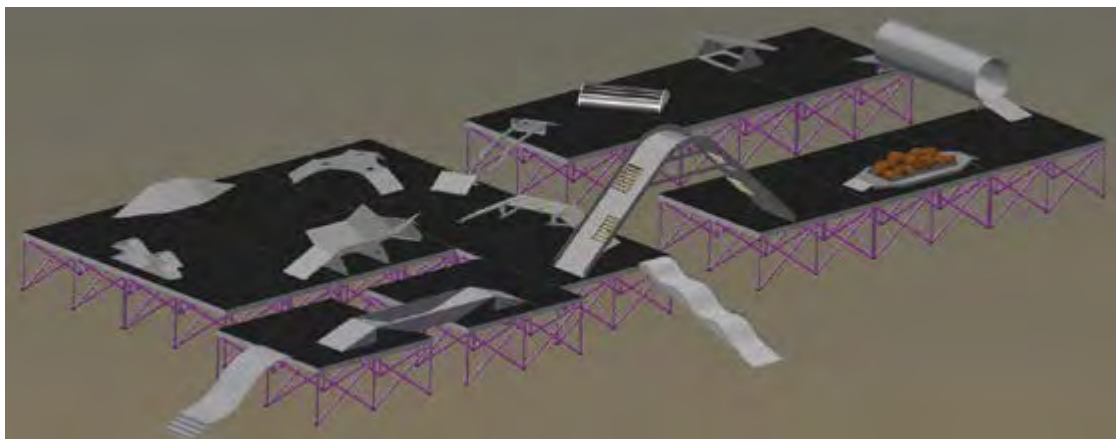



ABOVE & BEYOND



4x4 IN SCHOOLS

# Land Rover 4x4 in Schools Track Elements



Entry Ramp

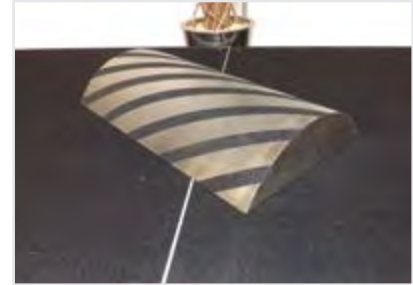

Camber Dome

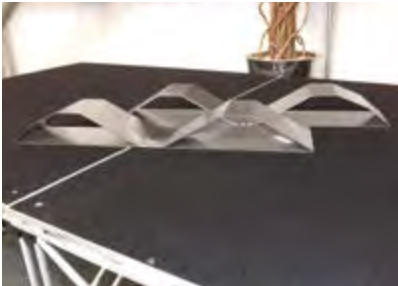

Articulation



V-Gully Traverse

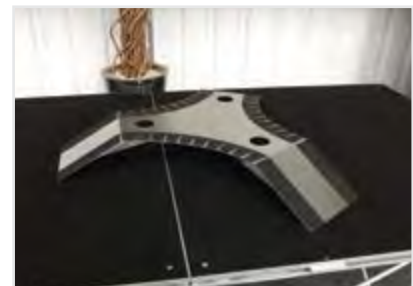

Hub



Pipe Bridge



Tunnel



See Saw



Off Ramp



Hill Climb



Low Mu Traverse



Side Slope



Rock Crawl



Water Tank Test